

- 超硬高速钢
- 三切刃, 大容量容屑槽
- 可沉孔加工
- 适合各类机床, 电钻倒角加工
- HSS-E
- Three cutting edges, large-capacity chip flute
- Counterbore processing is available
- Suitable for all kinds of machine tools, electric drill to chamfer

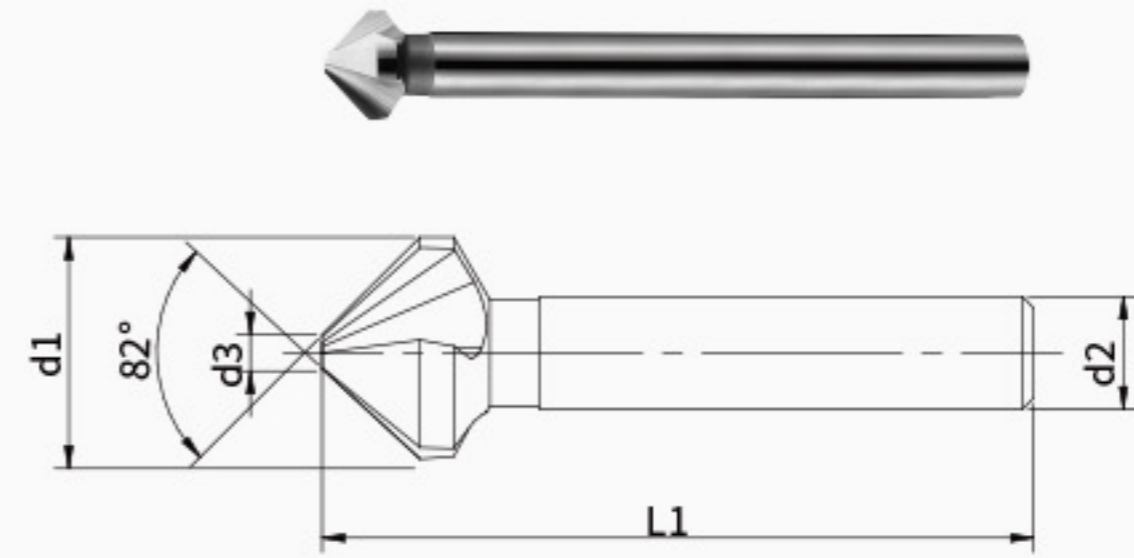

单位(Unit): inch(mm)

型号 MODEL	原型号 ORIGINAL MODEL	d1	d3	L1	d2
C10-EQC-0250	TGHQ-326	1/4" (6.35)	0.059 (1.5)	1.752 (44.5)	0.197 (5)
C10-EQC-0312	TGHQ-329	5/16" (7.9375)	0.079 (2)	1.929 (49)	0.236 (6)
C10-EQC-0375	TGHQ-325	3/8" (9.525)	0.087 (2.2)	1.929 (49)	0.236 (6)
C10-EQC-0500	TGHQ-321	1/2" (12.7)	0.110 (2.8)	2.205 (56)	0.315 (8)
C10-EQC-0625	TGHQ-322	5/8" (15.875)	0.126 (3.2)	2.362 (60)	0.394 (10)
C10-EQC-0750	TGHQ-323	3/4" (19.05)	0.138 (3.5)	2.441 (62)	0.394 (10)
C10-EQC-1000	TGHQ-324	1" (25.4)	0.150 (3.8)	2.717 (69)	0.394 (10)



C10-EXL

HSS X TYPE COUNTERSINK WITH WELDON SHANK (IMPERIAL) 高速钢X型直角柄铰钻 (英制)

- 超硬高速钢
- 三切削刃
- 磁座钻机适用
- HSS-E
- Three cutting edges
- Suitable for each kind of magnetic drilling machines to chamfer.

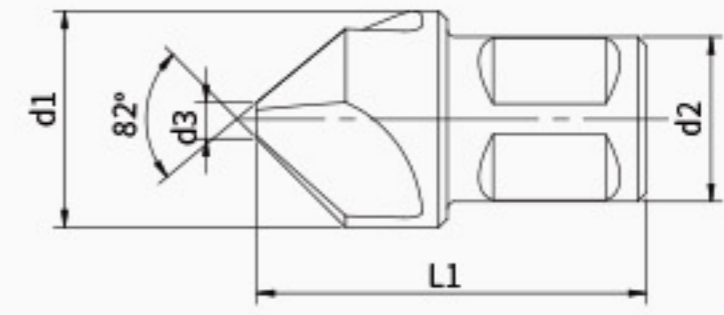

单位(Unit): inch(mm)

型号 MODEL	原型号 ORIGINAL MODEL	d1	d3	L1	d2
C10-EXL-0625	I-TCHX-333	5/8" (15.875)	0.102 (2.6)	1.693 (43)	3/4" (19.05)
C10-EXL-0750	I-TCHX-334	3/4" (19.05)	0.118 (3)	1.693 (43)	3/4" (19.05)
C10-EXL-1000	I-TCHX-332	1" (25.4)	0.177 (4.5)	1.772 (45)	3/4" (19.05)
C10-EXL-1500	I-TCHX-329	1-1/2" (38.1)	0.315 (8)	2.047 (52)	3/4" (19.05)
C10-EXL-2000	I-TCHX-331	2" (50.8)	0.394 (10)	2.362 (60)	3/4" (19.05)



C10-NLC

HSS S TYPE COUNTERSINK WITH TRIANGLE SHANK 高速钢S型三角柄铰钻

- 超硬高速钢
- 三刃切削刃, 大容量容屑槽
- 沉孔加工
- 适合各类机床, 电钻倒角加工
- HSS-E
- Three cutting edges, large-capacity chip flute
- Counterbore processing is available
- Suitable for all kinds of machine tools, electric drill to chamfer

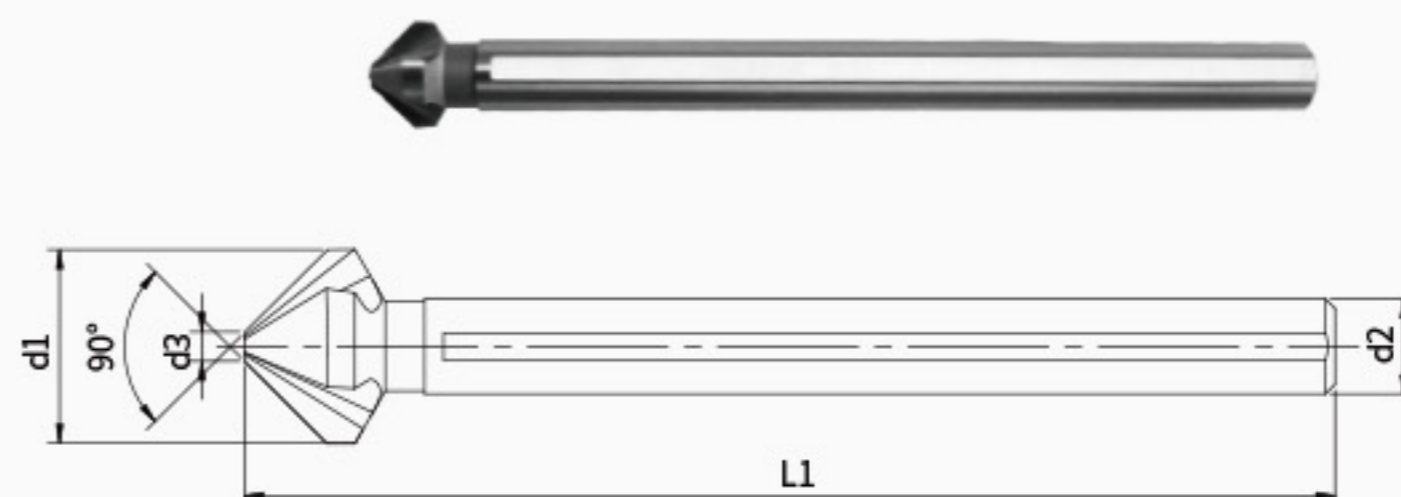

单位(Unit): mm

型号 MODEL	原型号 ORIGINAL MODEL	d1	d3	L1	d2	ISO 2009/2010/ 7046/7047	DIN 7991
C10-NLC-0063	TGHS-305	6.3	1.5	85	5	—	M3
C10-NLC-0083	TGHS-309	8.3	2	85	6	—	M4
C10-NLC-0104	TGHS-312	10.4	2.5	88	6	—	M5
C10-NLC-0124	TGHS-314	12.4	2.8	108	8	—	M6
C10-NLC-0150	TGHS-316	15	3.2	110	10	M8	—
C10-NLC-0165	TGHS-317	16.5	3.2	112	10	—	M8
C10-NLC-0205	TGHS-319	20.5	3.5	115	10	—	M10
C10-NLC-0250	TGHS-321	25	3.8	118	10	—	M12



C10-NML

HSS COUNTERSINK WITH MORSE TAPER SHANK 高速钢莫氏锥柄铰钻

- 超硬高速钢
- 三刃切削刃, 大容量容屑槽
- 可沉孔加工
- HSS-E
- Three cutting edges, large-capacity chip flute
- Counterbore processing is available

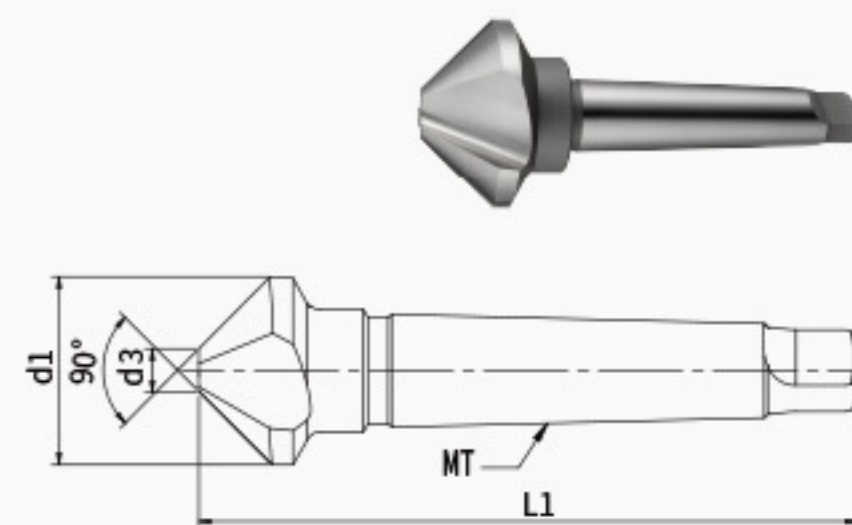

单位(Unit): mm

型号 MODEL	原型号 ORIGINAL MODEL	d1	d3	L1	MT	ISO 2009/2010/ 7046/7047	DIN 7991
C10-NML-0205	TCHM-301	20.5	3.5	100	2	—	M10
C10-NML-0250	TCHM-302	25	3.8	106	2	—	M12
C10-NML-0310	TCHM-303	31	4.2	112	2	—	M16
C10-NML-0370	TCHM-304	37	4.8	118	2	M20	M20
C10-NML-0400	TCHM-305	40	10	140	3	—	—
C10-NML-0500	TCHM-306	50	14	150	3	—	—
C10-NML-0630	TCHM-307	63	16	180	4	—	—
C10-NML-0800	TCHM-308	80	22	190	4	—	—

C10-SML

HSS COUNTERSINK WITH MORSE TAPER SHANK 高速钢莫氏锥柄铰钻

- 超硬高速钢
- 三刃切削刃, 大容量容屑槽
- 可沉孔加工
- HSS-E
- Three cutting edges, large-capacity chip flute
- Counterbore processing is available

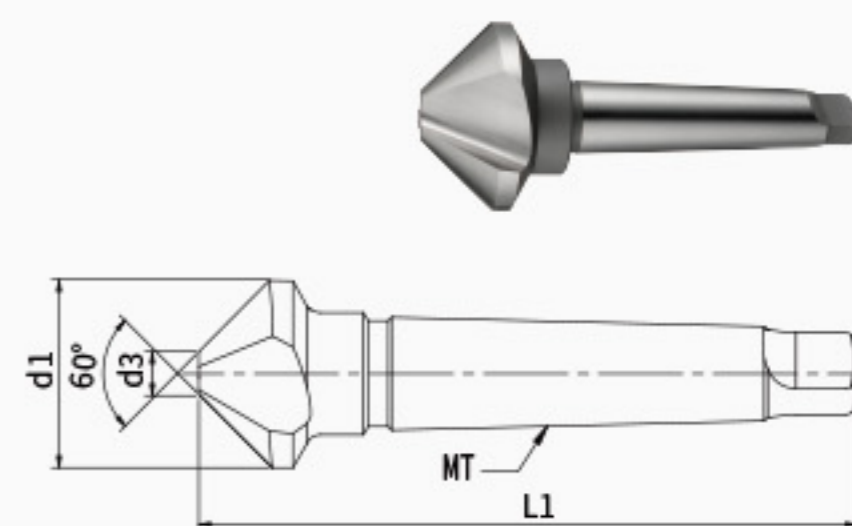

单位(Unit): mm

型号 MODEL	原型号 ORIGINAL MODEL	d1	d3	L1	MT
C10-SML-0200	TCHM-309	20	5	106	2
C10-SML-0250	TCHM-302	25	6.3	112	2
C10-SML-0315	TCHM-310	31.5	10	118	2
C10-SML-0400	TCHM-305	40	12.5	150	3
C10-SML-0500	TCHM-306	50	16	160	3
C10-SML-0630	TCHM-307	63	20	190	4
C10-SML-0800	TCHM-308	80	25	200	4



- 超硬高速钢
- 三刃切削刃, 大容量容屑槽
- 沉孔加工, 适用DIN74, DIN75
- 适合各类机床, 电钻倒角加工
- HSS-E
- Three cutting edges, large-capacity chip flute
- Counterbore processing is available
- Suitable for all kinds of machine tools, electric drill to chamfer

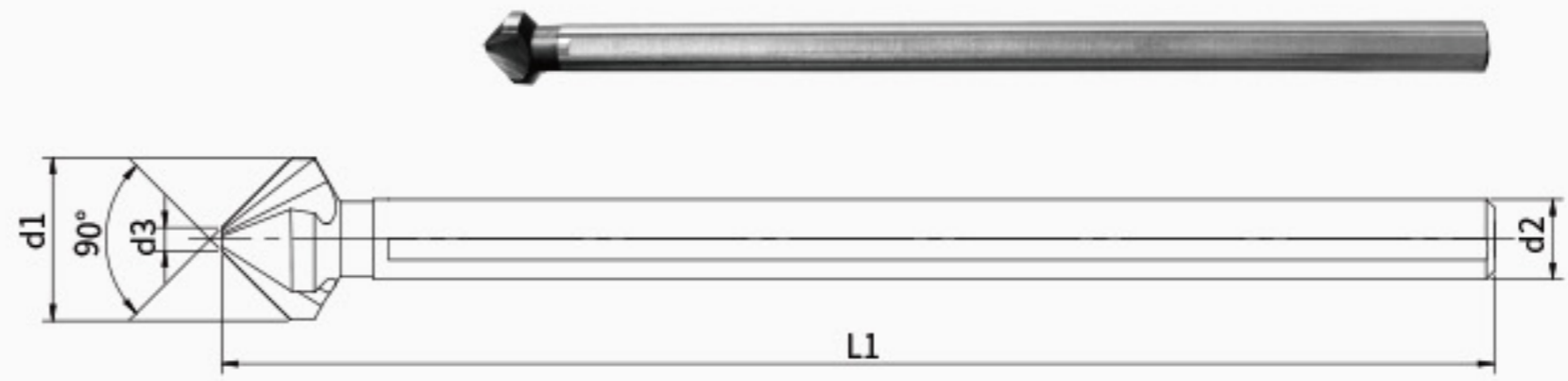

单位(Unit): mm

型号 MODEL	原型号 ORIGINAL MODEL	d1	d3	L1	d2	ISO 2009/2010/ 7046/7047	DIN 7991
C10-NOC-0063	TGHS-305	6.3	1.5	154	5	—	M3
C10-NOC-0083	TGHS-309	8.3	2	155	6	—	M4
C10-NOC-0104	TGHS-312	10.4	2.5	157	6	—	M5
C10-NOC-0124	TGHS-314	12.4	2.8	158	8	—	M6
C10-NOC-0150	TGHS-316	15	3.2	158	10	M8	—
C10-NOC-0165	TGHS-317	16.5	3.2	161	10	—	M8
C10-NOC-0205	TGHS-319	20.5	3.5	164	10	—	M10
C10-NOC-0250	TGHS-321	25	3.8	164	10	—	M12



- 超硬高速钢
- 三刃切削刃
- 可沉孔加工
- 适合各类机床, 电钻倒角加工
- HSS-E
- Three cutting edges, capacity chip flute
- Counterbore processing is available
- Suitable for all kinds of machine tools, electric drill to chamfer

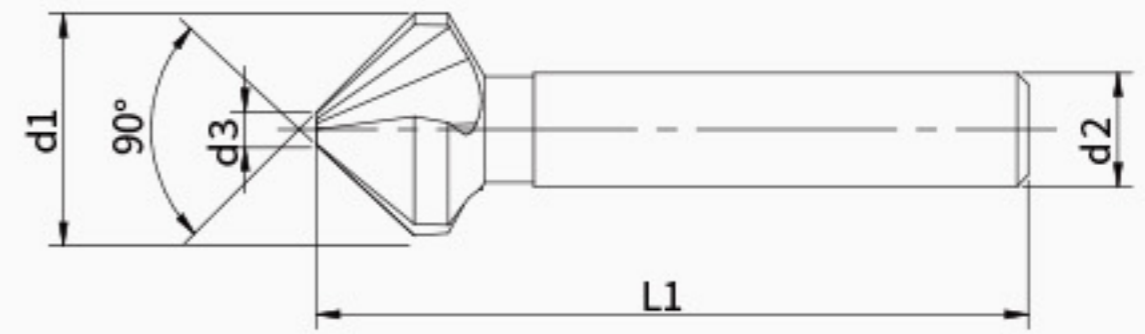

单位(Unit): mm

型号 MODEL	原型号 ORIGINAL MODEL	d1	d3	L1	d2	ISO 2009/2010/ 7046/7047	DIN 7991
C10-NQL-0060	TCHQ-323	6	1.5	45	5	M3	—
C10-NQL-0063	TCHQ-301	6.3	1.5	45	5	—	M3
C10-NQL-0083	TCHQ-324	8.3	2	50	6	—	M4
C10-NQL-0100	TCHQ-314	10	2.5	50	6	M5	—
C10-NQL-0104	TCHQ-312	10.4	2.5	50	6	—	M5
C10-NQL-0124	TCHQ-304	12.4	2.8	56	8	—	M6
C10-NQL-0150	TCHQ-322	15	3.2	60	10	M8	—
C10-NQL-0165	TCHQ-305	16.5	3.2	60	10	—	M8
C10-NQL-0200	TCHQ-315	20	3.5	63	10	—	—
C10-NQL-0205	TCHQ-306	20.5	3.5	63	10	—	M10
C10-NQL-0250	TCHQ-307	25	3.8	67	10	—	M12
C10-NQL-0310	TCHQ-308	31	4.2	71	12	—	M16
C10-NQL-0400	TCHQ-309	40	7	100	15	—	—



- 粉末高速钢
- 三切削刃, 大容量屑槽
- 可沉孔加工
- 适合各类机床, 电钻倒角加工

- HSS-PM
- Three cutting edges, large-capacity chip flute
- Counterbore processing is available
- Suitable for all kinds of machine tools, electric drill to chamfer

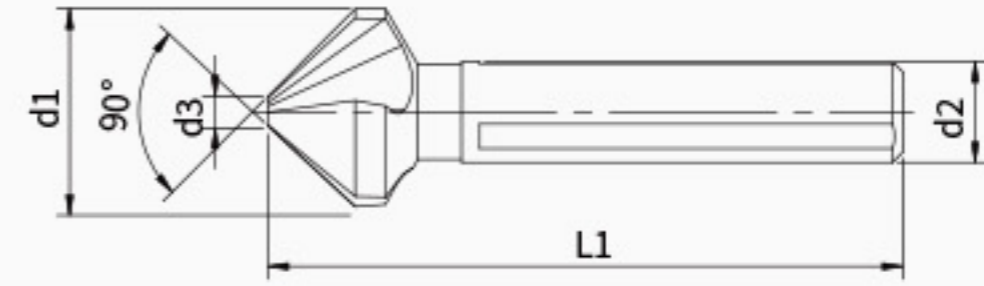

单位(Unit): mm

型号 MODEL	原型号 ORIGINAL MODEL	d1	d3	L1	d2	ISO 2009/2010/ 7046/7047	DIN 7991
C12-NSC-0063	TGAS-305	6.3	1.5	45	5	—	M3
C12-NSC-0083	TGAS-309	8.3	2	50	6	—	M4
C12-NSC-0104	TGAS-312	10.4	2.5	50	6	—	M5
C12-NSC-0124	TGAS-314	12.4	2.8	56	8	—	M6
C12-NSC-0165	TGAS-317	16.5	3.2	60	10	—	M8
C12-NSC-0205	TGAS-319	20.5	3.5	63	10	—	M10
C12-NSC-0250	TGAS-321	25	3.8	67	10	—	M12
C12-NSC-0310	TGAS-325	31	4.2	71	12	—	M16



- 超硬高速钢
- 三刃切削刃, 大容量容屑槽
- 沉孔加工
- 适合各类机床, 电钻倒角加工
- HSS-E
- Three cutting edges, large-capacity chip flute
- Counterbore processing is available
- Suitable for all kinds of machine tools, electric drill to chamfer

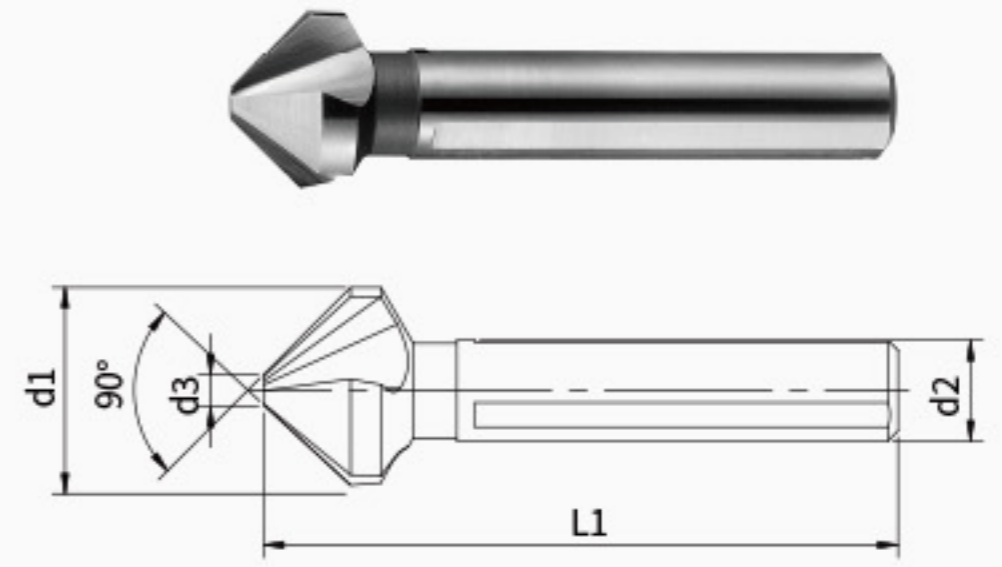

单位(Unit): mm

型号 MODEL	原型号 ORIGINAL MODEL	d1	d3	L1	d2	ISO 2009/2010/ 7046/7047	DIN 7991
C10-NSC-0043	TGHS-301	4.3	1.3	40	4	M2	—
C10-NSC-0050	TGHS-302	5	1.5	40	4	M2.5	—
C10-NSC-0053	TGHS-303	5.3	1.5	40	4	—	—
C10-NSC-0060	TGHS-304	6	1.5	45	5	M3	—
C10-NSC-0063	TGHS-305	6.3	1.5	45	5	—	M3
C10-NSC-0070	TGHS-306	7	1.8	50	6	M3.5	—
C10-NSC-0073	TGHS-307	7.3	1.8	50	6	—	—
C10-NSC-0080	TGHS-308	8	2	50	6	M4	—
C10-NSC-0083	TGHS-309	8.3	2	50	6	—	M4
C10-NSC-0094	TGHS-310	9.4	2.2	50	6	—	—
C10-NSC-0100	TGHS-311	10	2.5	50	6	M5	—
C10-NSC-0104	TGHS-312	10.4	2.5	50	6	—	M5
C10-NSC-0115	TGHS-313	11.5	2.8	56	8	M6	—
C10-NSC-0124	TGHS-314	12.4	2.8	56	8	—	M6
C10-NSC-0134	TGHS-315	13.4	2.9	56	8	—	—
C10-NSC-0150	TGHS-316	15	3.2	60	10	M8	—
C10-NSC-0165	TGHS-317	16.5	3.2	60	10	—	M8
C10-NSC-0190	TGHS-318	19	3.5	63	10	M10	—
C10-NSC-0205	TGHS-319	20.5	3.5	63	10	—	M10
C10-NSC-0230	TGHS-320	23	3.8	67	10	M12	—
C10-NSC-0250	TGHS-321	25	3.8	67	10	—	M12
C10-NSC-0260	TGHS-322	26	3.9	71	12	M14	—
C10-NSC-0280	TGHS-323	28	4	71	12	—	M14
C10-NSC-0300	TGHS-324	30	4.1	71	12	M16	—
C10-NSC-0310	TGHS-325	31	4.2	71	12	—	M16



C10-NXL

HSS X TYPE COUNTERSINK WITH WELDON SHANK 高速钢X型直角柄铰钻

- 超硬高速钢
- 三切削刃
- 磁座钻机适用
- HSS-E
- Three cutting edges
- Suitable for each kind of magnetic drilling machines to chamfer.

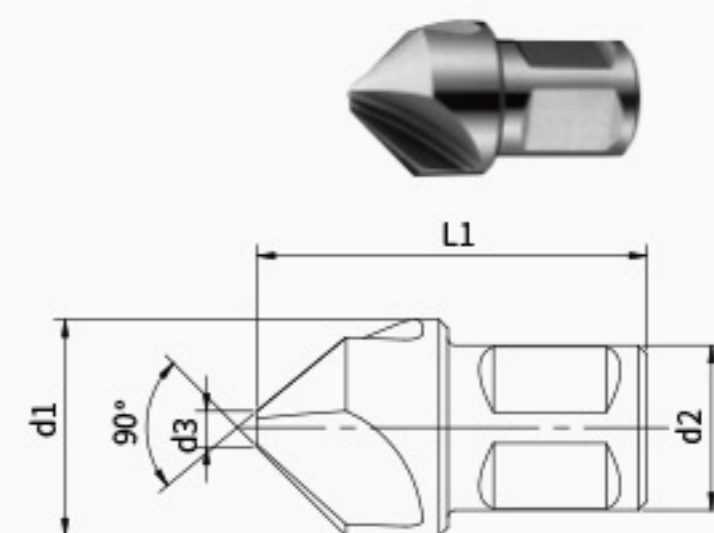

单位(Unit): mm

型号 MODEL	原型号 ORIGINAL MODEL	d1	d3	L1	d2	ISO 2009/2010/ 7046/7047	DIN 7991
C10-NXL-0250	TCHX-301	25	4.5	45	19.05	—	M12
C10-NXL-0300	TCHX-302	30	4.5	47	19.05	M16	—
C10-NXL-0400	TCHX-303	40	8	52	19.05	—	—
C10-NXL-0500	TCHX-304	50	10	57	19.05	—	—
C10-NXL-0550	TCHX-305	55	10	60	19.05	—	—

C10-NXL

HSS X TYPE COUNTERSINK WITH WELDON SHANK (IMPERIAL) 高速钢X型直角柄铰钻 (英制)

- 超硬高速钢
- 三切削刃
- 磁座钻机适用
- HSS-E
- Three cutting edges
- Suitable for each kind of magnetic drilling machines to chamfer.

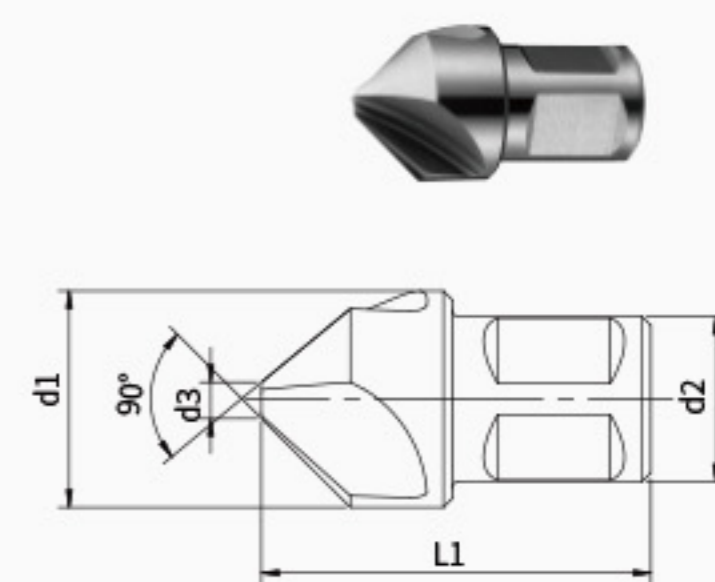

单位(Unit): inch(mm)

型号 MODEL	原型号 ORIGINAL MODEL	d1	d3	L1	d2
C10-NXL-1250	I-TCHX-302	1-1/4" (31.75)	0.197 (5)	1.850 (47)	3/4" (19.05)
C10-NXL-1500	I-TCHX-306	1-1/2" (38.1)	0.315 (8)	2.047 (52)	3/4" (19.05)
C10-NXL-2000	I-TCHX-304	2" (50.8)	0.394 (10)	2.244 (57)	3/4" (19.05)



C10-SSC

HSS S TYPE COUNTERSINK WITH TRIANGLE SHANK 高速钢S型三角柄铰钻

- 超硬高速钢
- 三刃切削刃, 大容量容屑槽
- 适合各类机床, 电钻倒角加工
- HSS-E
- Three cutting edges, large-capacity chip flute
- Suitable for all kinds of machine tools, electric drill to chamfer

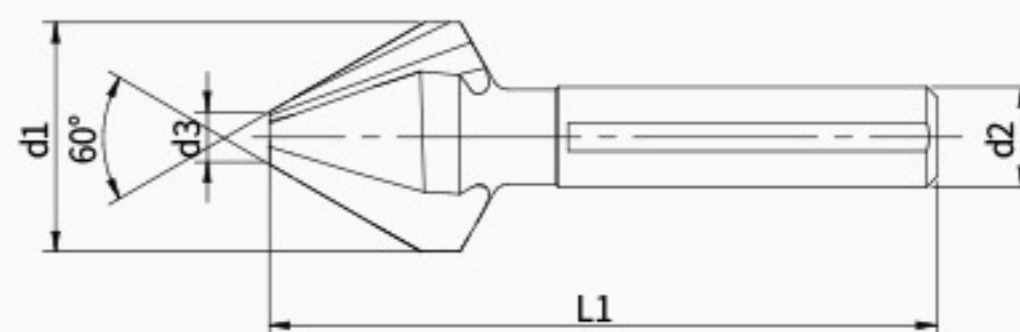

单位(Unit): mm

型号 MODEL	原型号 ORIGINAL MODEL	d1	d3	L1	d2
C10-SSC-0063	TGHS-305	6.3	1.5	45	5
C10-SSC-0080	TGHS-308	8	2	50	6
C10-SSC-0100	TGHS-311	10	2.5	50	6
C10-SSC-0250	TGHS-321	25	3.8	67	10

C10-TSC

HSS S TYPE COUNTERSINK WITH TRIANGLE SHANK 高速钢S型三角柄铰钻

- 超硬高速钢
- 三刃切削刃, 大容量容屑槽
- 适合各类机床, 电钻倒角加工
- HSS-E
- Three cutting edges, large-capacity chip flute
- Suitable for all kinds of machine tools, electric drill to chamfer

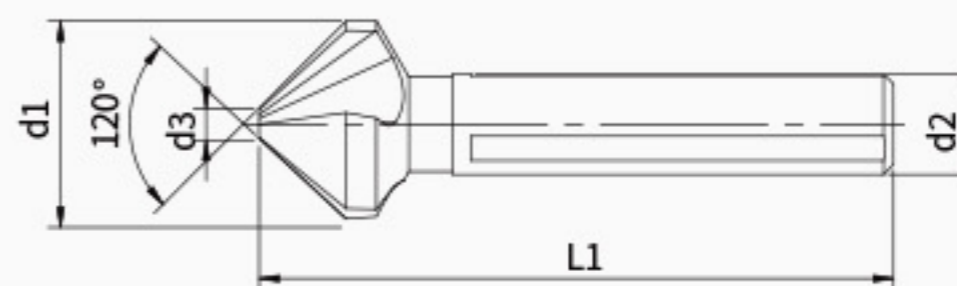

单位(Unit): mm

型号 MODEL	原型号 ORIGINAL MODEL	d1	d3	L1	d2
C10-TSC-0063	TGHS-305	6.3	1.5	45	5
C10-TSC-0083	TGHS-309	8.3	2	50	6
C10-TSC-0104	TGHS-312	10.4	2.5	50	6
C10-TSC-0124	TGHS-314	12.4	2.8	56	8
C10-TSC-0165	TGHS-317	16.5	3.2	60	10
C10-TSC-0205	TGHS-319	20.5	3.5	63	10
C10-TSC-0250	TGHS-321	25	3.8	67	10



C30-NQC

CARBIDE Q TYPE COUNTERSINK WITH CYLINDRICAL SHANK 硬质合金Q型圆柱柄铰钻

- 特殊槽型, 刃口锋利
- Special groove, sharp edge

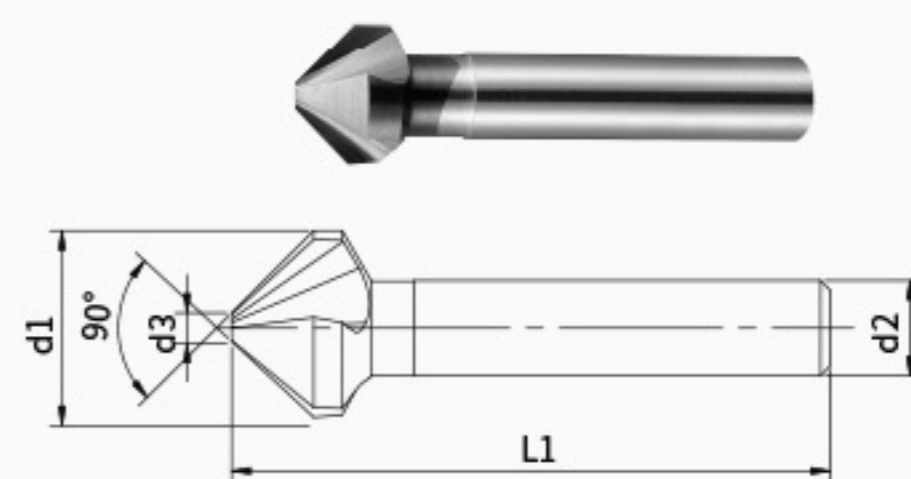

单位(Unit): mm

型号 MODEL	原型号 ORIGINAL MODEL	d1	d3	L1	d2	DIN74	
						AF	BF
C30-NQC-0063	TGTQ-305	6.3	1.5	45	5	M3	—
C30-NQC-0083	TGTQ-309	8.3	2	50	6	M4	—
C30-NQC-0104	TGTQ-312	10.4	2.5	50	6	—	M5
C30-NQC-0124	TGTQ-314	12.4	2.8	56	8	—	M6
C30-NQC-0165	TGTQ-317	16.5	3.2	60	10	—	M8
C30-NQC-0205	TGTQ-319	20.5	3.5	63	10	—	M10
C30-NQC-0250	TGTQ-321	25	3.8	67	10	—	M12
C30-NQC-0310	TGTQ-325	31	4.2	71	12	—	—

C30-NQH

CARBIDE Q TYPE COUNTERSINK WITH CYLINDRICAL SHANK (HARD CUTTING) 硬质合金Q型圆柱柄铰钻 (硬切削)

- 适用大于HRC30的被加工材料
- 硬材料专用切削几何
- Applicable to processed materials HRC more than 30
- Special cutting geometry for hard materials

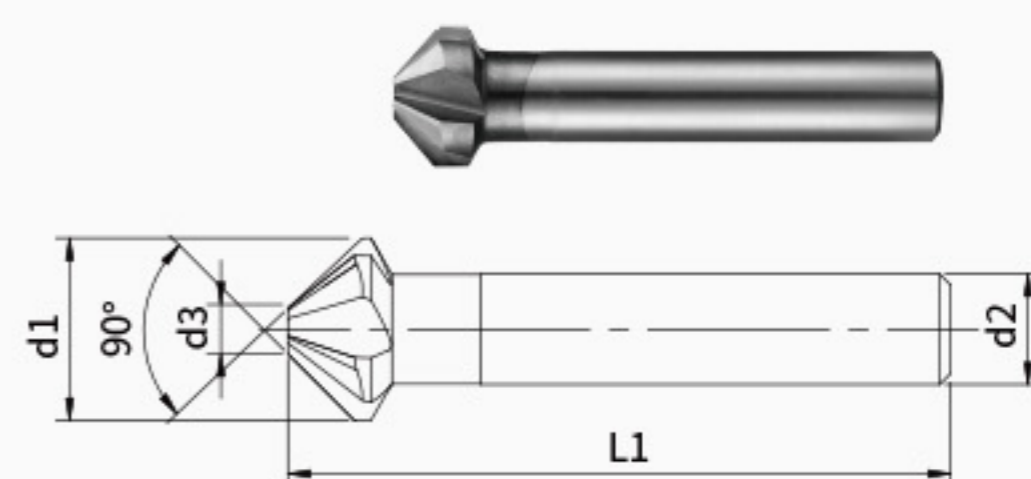

单位(Unit): mm

型号 MODEL	原型号 ORIGINAL MODEL	d1	d3	L1	d2
C30-NQH-0104	TYTQ-412	10.4	4	46	8
C30-NQH-0124	TYTQ-514	12.4	4	56	8
C30-NQH-0165	TYTQ-517	16.5	4.5	60	10
C30-NQH-0205	TYTQ-519	20.5	5	63	10
C30-NQH-0250	TYTQ-521	25	5.5	67	10
C30-NQH-0310	TYTQ-525	31	6	71	12

